

INDEX

- Lift
- Cloakroom
- Roof terrace
- Viewpoint
- Sanctuary of La Fontaine
- Toilets
- Beginning/end of exhibition
- Temporary exhibition
- 1 2 3 ... Works
- Brasserie : *La Table du 2*
- Exit
- Museum shop

The brasserie and the roof terrace are accessible through the corridor next to rue de la République, independently of the visit circuit.

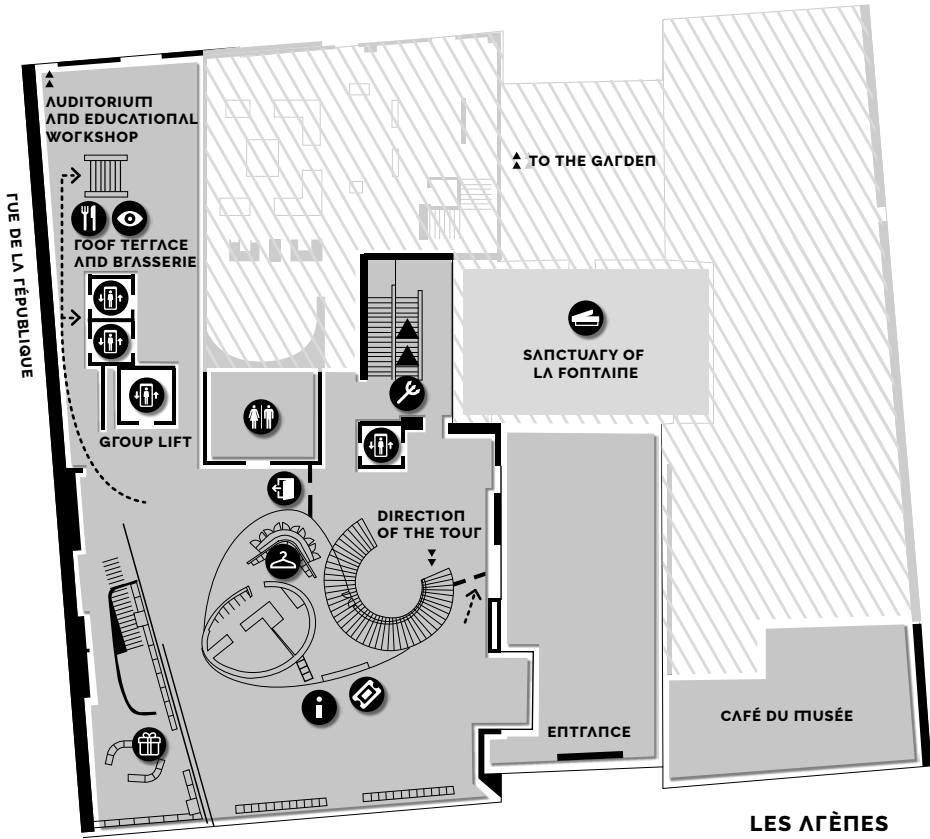

LEVEL 1

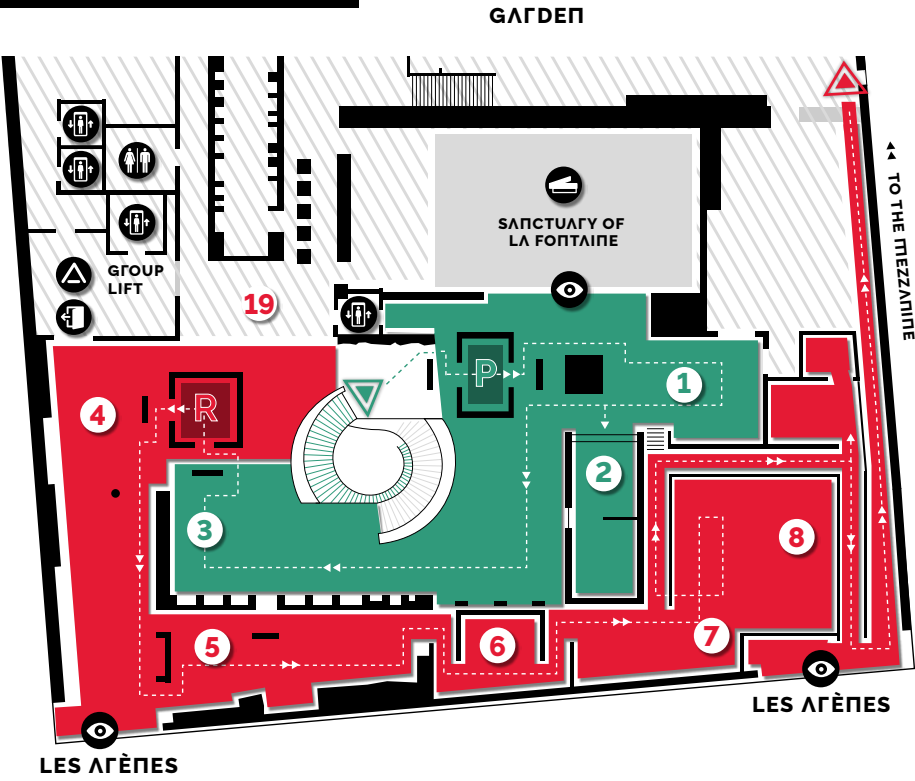

THE PRE-ROMAN ERA (800 - 100 BC)

Discover the daily life and rites of the Arecomic Volques, the Gaulish people who settled on the site of Nîmes around the Source of La Fontaine, well before the Roman colony. The numerous traces and objects found enable reconstitution of the way of life of a society that was already economically very important.

- 1 The warrior of Grézan | 2 Gailhan's house
3 Colonial and Roman currencies



THE ROMAN ERA (27 BC - AD 400)

At the end of the Caesarean era (44 years before our era), Nîmes became a colony and took the name of Colonia Augusta Nemausus. Compare the city of today with the traces of the past and immerse yourself in Roman civilisation.

- 4 Urban development | 5 Architectural decor
6 Housing and private decor | 7 The statue of Neptune
8 The mosaic of Pentheus



MEZZANINE

- 9 Mosaics and frescoes
10 The Cubiculum of Brignon | 11 The mosaic of Bellerophon

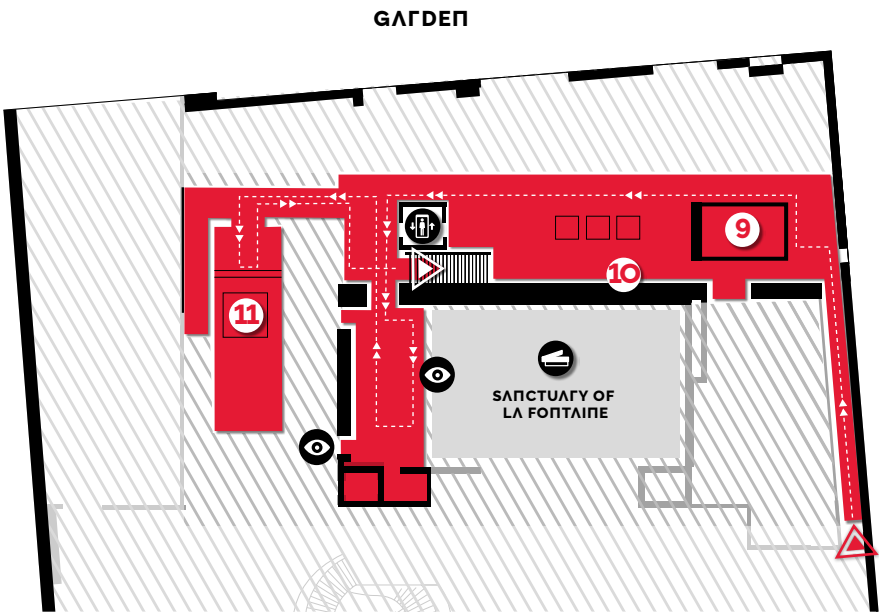
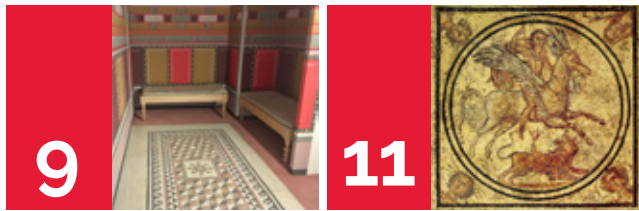

LEVEL 1

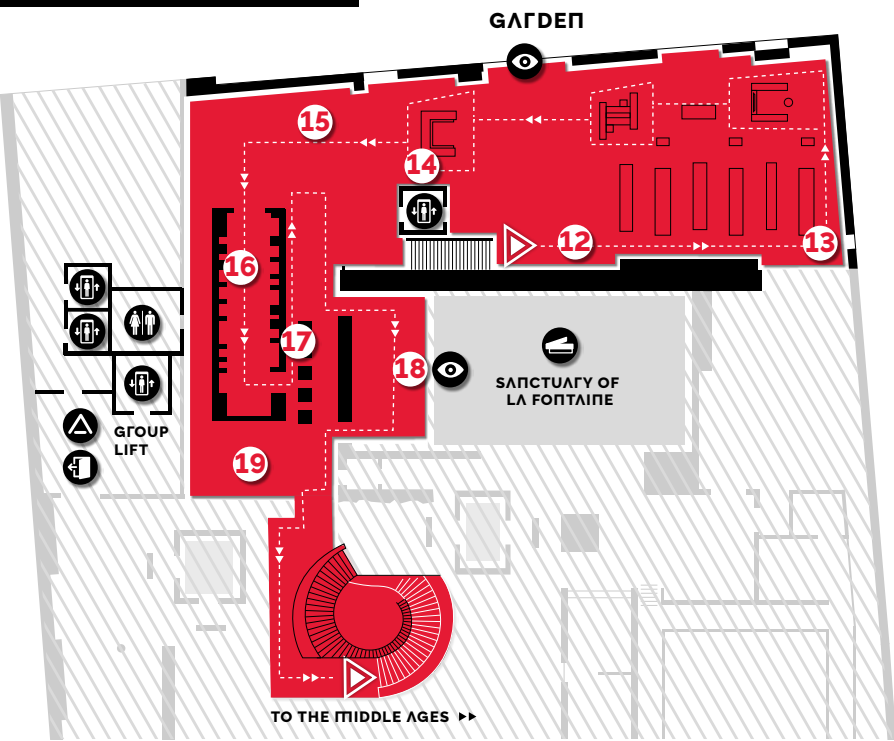

- 12 Epigraphy | 13 Roman Society
14 Currencies and imperial dynasties | 15 The dolium
16 The religions | 17 Funeral practices
18 The Sanctuary of La Fontaine | 19 The statues of Beaucaire

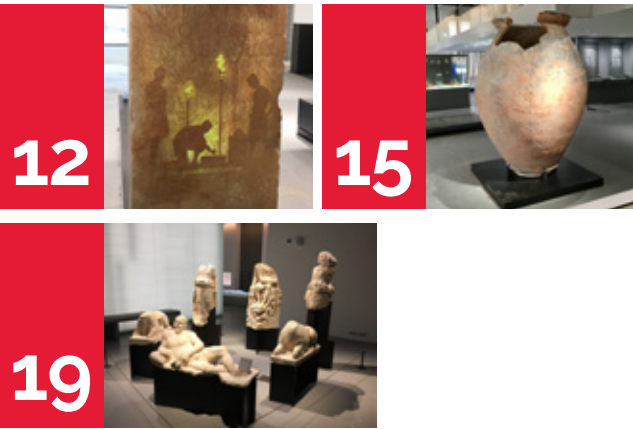

Rest of the visit via the staircase : turn the map

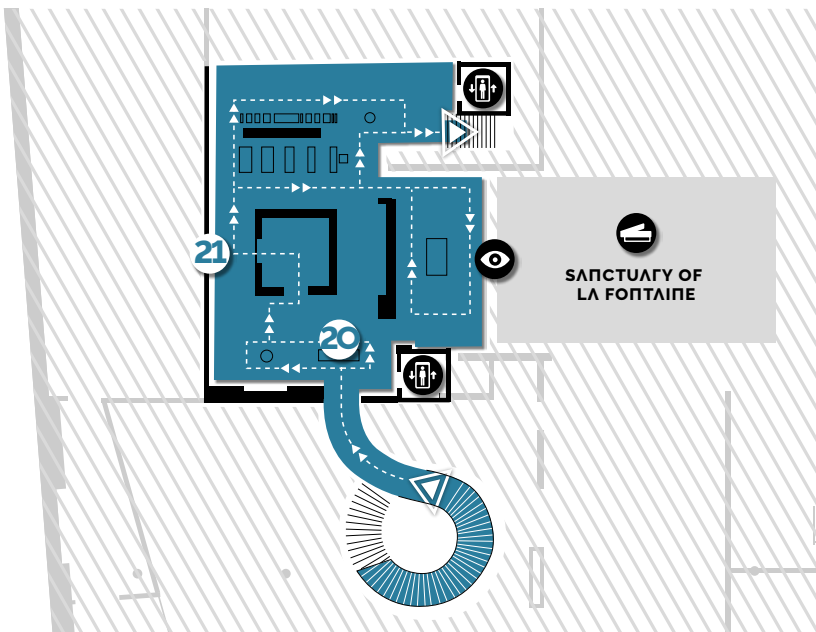

M THE MIDDLE AGES (1000 - 1500)

Let yourself be carried away by the wealth of the mediaeval imagination : architectural decor, fantastic bestiaries, biblical characters and ancient influences..

20 The sarcophagus of Valbonne | **21** The battle of the monsters



22 The frieze of Saint-Martin des Arènes

L THE LEGACY OF ANTIQUITY

Discover the interest that Roman civilisation has attracted over the centuries and create your own selection of references on a giant screen.

23 The collectors | **24** The models of Auguste Pellet

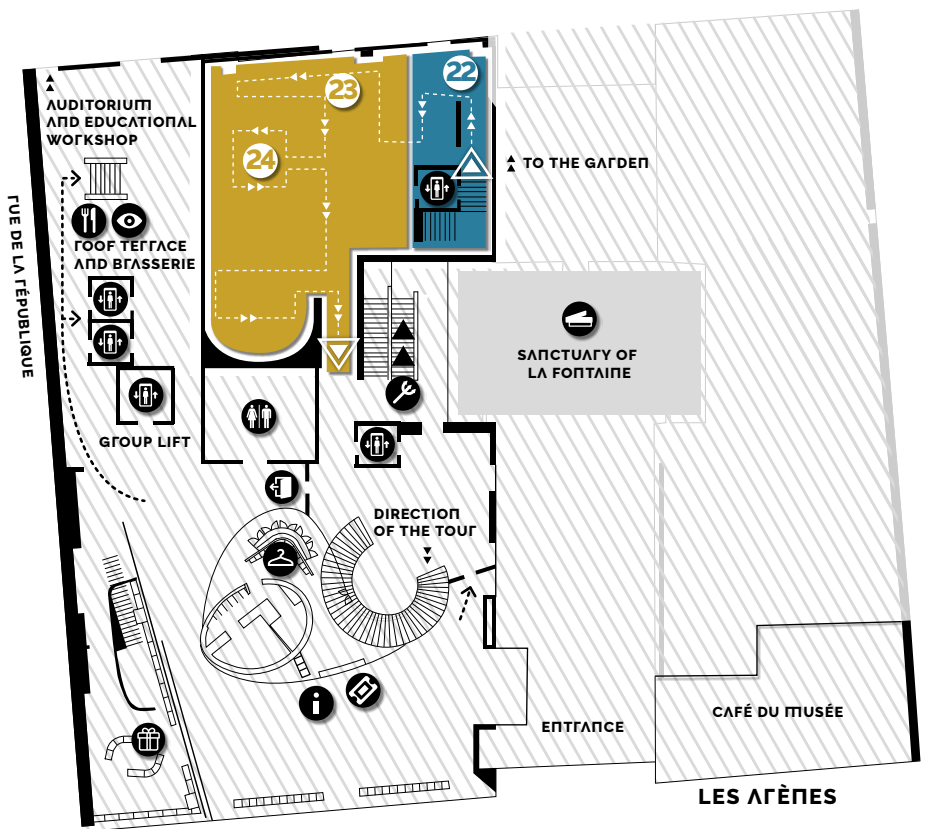
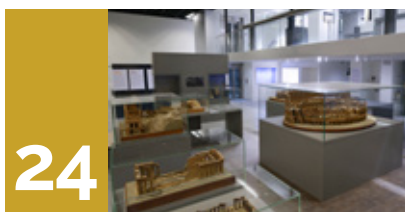

ENJOY A HISTORICAL EXPERIENCE

Discover the Nîmes region and the lives of the people who lived there for 25 centuries. The 5000 items exposed, from amongst a rich archaeological collection of 25,000 items collected in Nîmes and its environs, bear witness to the process of romanisation, which took place in the region nearly 2000 years ago. Four chronological sequences, connected by knowledge boxes, each one acting as a veritable enclosure in time and space, lead you

from the Iron Age (the Gaulish period before Roman civilisation), through the Roman period, the Middle Ages and then the Roman legacy throughout the centuries. A veritable entrance door to understanding the city, the Museum invites you to a journey through history, following the fabulous traces of the past, which will enable you to share their daily lives and the wealth of their civilisation.